

MadFlex 11 mm TOP PERFORMANCE

Substantially not deformable on the rigid side, this MadFlex has an extremely high tensile resistance and excels in flexural strength. It can be used to replace structural metallic part, allowing a considerable lightening: a panel of this type, weighing 1.8 kg, corresponds to a 3.5 mm thick aluminum sheet weighing 10 kg and having a 5 times higher environmental impact. It also shows excellent insulating properties.

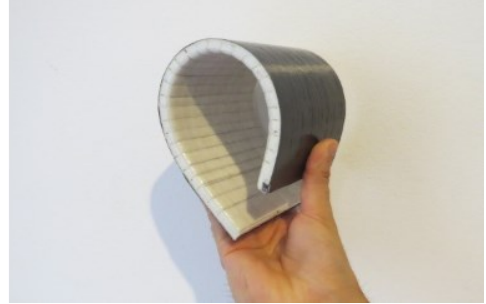
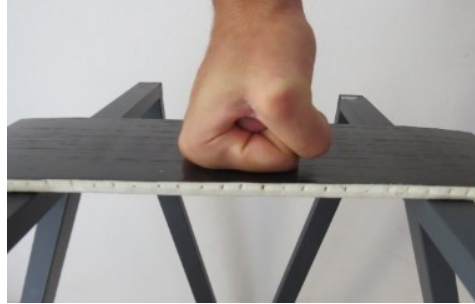

	UNIT	TYPICAL VALUE	TEST
Thickness	mm	11	
Areal weight	kg/m ²	1.8	
Tensile strength	kN/m	700	ASTM D3039/D3039M
Failure bending moment	N·m/m	480	ASTM D7250/D7250M
Bending stiffness "rigid side"	N·m ² /m	240	ASTM D7250/D7250M
Bending stiffness "flexible side"	N·m ² /m	1.5	ASTM D7250/D7250M
Flatwise compressive strength	MPa	1.5	ASTM C365/C365M
Heat transfer coefficient	W/ m ² °K	3.6	DIN52612

Maximum load for a 0,5 m x 0,5 m panel for two different restraint conditions:

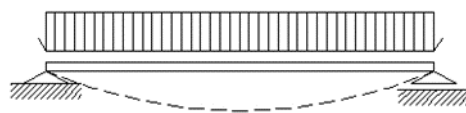

Simple supports: 780 kg

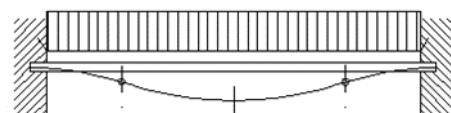

Fixed supports: 16,400 kg

OTHER FEATURES

- Flame resistant
- A 10 m long panel can be wrapped into a 30 cm diameter
- It can tolerate above 100 thousand cycles of rolling up, preserving 2/3 of its mechanical strength
- Thermoformable in plane or curved shapes
- Great resistance to atmospheric agents and UV radiation
- Great resistance to chemical agents (eg hydrocarbons)
- Biocompatible